

# ImagePASS-M1/ Network Multi-PDL Printer Unit-M1 Installation Procedure

## 1 Unpacking and Check of Included Items

Unpack the shipping box, and check to make sure that none of the following is missing:

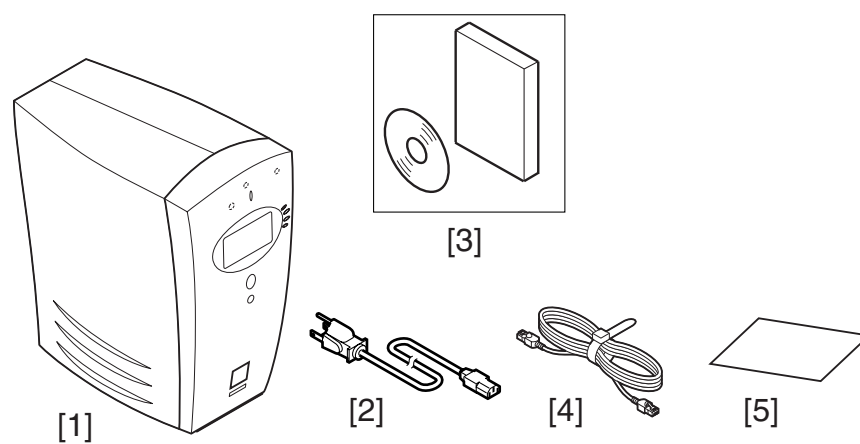

Fig. 1-1

- [1] Main unit
- [2] Power cable
- [3] Media Pack
- [4] Cross Ethernet cable
- [5] Network Interface Adapter



**2 Install the Network Interface Adapter**

- 1) Turn off the main power switch.
- 2) Remove the screws [1] (10), and remove the rear cover [2].

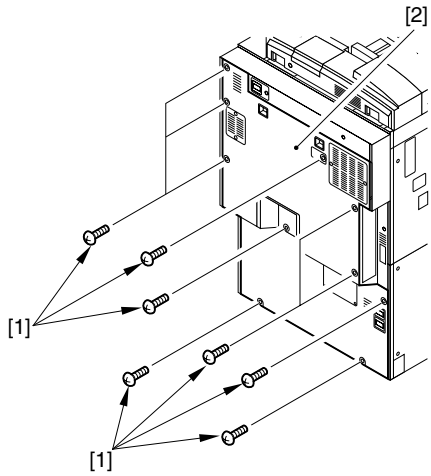

Fig. 2-1

- 3) Remove the interface cable [1].

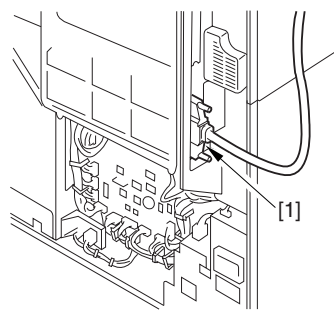

Fig. 2-2

- 4) Remove the screws [1] (2), and remove the rear right cover [2].

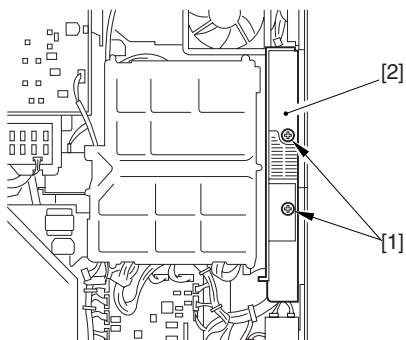

Fig. 2-3

- 5) Remove the screws [1] (4), and pull the main controller box [2] out.

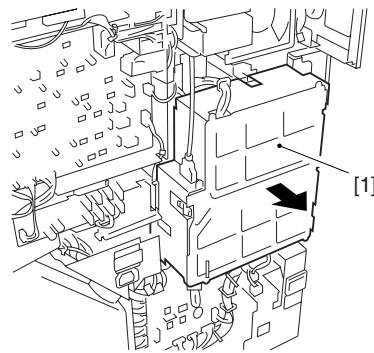
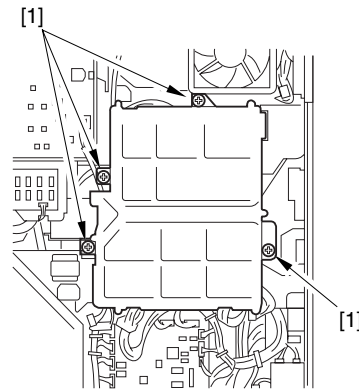

Fig. 2-4

- 6) Remove the screws [1] (2), and remove the blanking plate 1 [2].

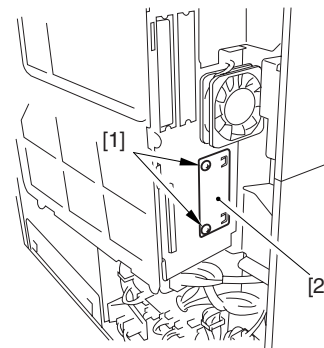

Fig. 2-5



- 7) Fix the network PCB [1] with the screws for attaching the blanking plate 1 [2] (2).

**Caution:**

⚠ Make sure that the connector is inserted properly.

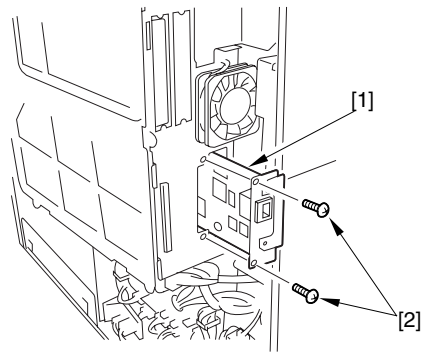

Fig. 2-6

- 8) Push the main controller box (pulled out in Procedure 5)) in, and fix it with screws (4).  
9) Attach the rear right cover removed in Procedure 3).  
10) Attach the interface cable removed in Procedure 2).  
11) Attach the rear cover removed in Procedure 1).

### 3 Preliminary Adjustment

- 1) Turn a connected device ON.
- 2) Check to make sure that the version of COPIER> DISPLAY> VERSION> MN-CONT in Service Mode is 10.53 or later. If the version is earlier than 10.53, upgrade MN-CONT using Service Support Tool.
- 3) Set '1' to COPIER> OPTION> INT-FACE> IMG-CONT in Service mode.

## 4 Installation

- 1) Connect the cross Ethernet cable [1] to the RJ45 connector on which a copier mark is engraved at the back of the main unit.

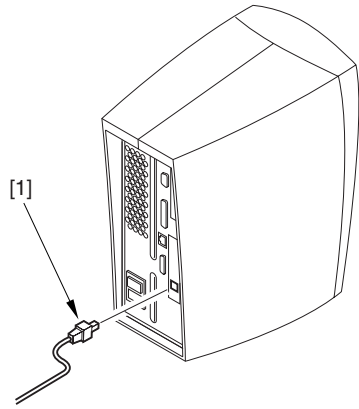

Fig. 4-1

- 2) Connect the other side of the cross Ethernet cable [1] which is connected to the main unit in the procedure 1) to the RJ45 connector of the connected device.

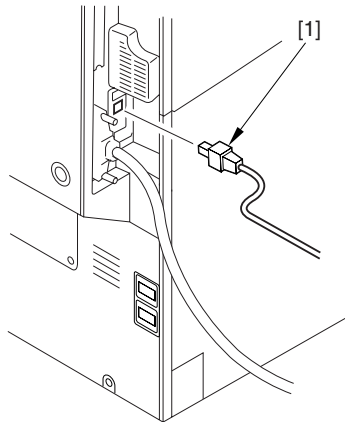

Fig. 4-2

- 3) Turn the connected device ON.
- 4) Connect the power cable [1] to the main unit.

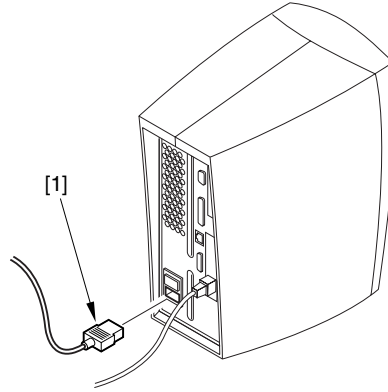

Fig. 4-3

- 5) Turn the main unit [1] ON and wait until "Idle" is indicated on the LCD.

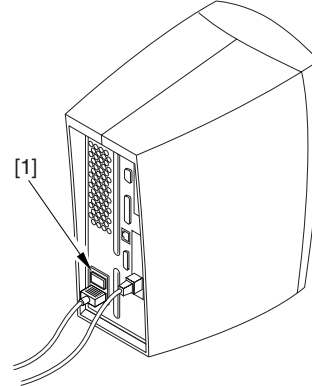

Fig. 4-4

- 6) Inform a system administrator of the customer that the installation completes, and ask the person to make settings of the imagePASS-M1.